



# C72

Wheel balancer with microprocessor for car, light commercial vehicle and motorcycle wheels



# CEMB

BALANCING MACHINES



# C72

Wheel balancer with microprocessor for car, light commercial vehicle and motorcycle wheels

## ► General features



- ▷ Low balancing speed to reduce spin times.
- ▷ Gauge for automatic measurement of distance and diameter, and as an aid for the application of adhesive weights.
- ▷ Fully automatic cycle: START closing guard, measurement and braking. Automatic stop in the correction zone.
- ▷ Pedal-operated brake for wheel locking.
- ▷ Cone and adapter holders.
- ▷ Software menu for selecting options and customisations (grams/ounces; inches/millimetres; display of unbalance in 5 by 5 grams or 1 by 1 gram; tolerance threshold; automatic start; etc.).

- ▷ Self diagnostics and Self-calibration, for a simple maintenance.
- ▷ Balancing Mode:
  - on two planes
  - ALU-S** (for correction inside the rim)
  - Static (for motorcycle wheels)
  - ALU for correction with the various application positions of different types of counterweights, clearly indicated on the display.
- ▷ **SPLIT** Program (or Hidden Weight) to hide the counterweight behind the spokes of the rim.
- ▷ **OPTIMIZATION** Program to reduce total unbalance and improve wheel eccentricity, comfort and silent operation.
- ▷ Eccentricity measuring system (1st Harmonic and Peak to Peak) with **EMS Sonar** (option). Automatic start during balancing cycle allowing operators to get the information about wheel eccentricity without any time loss.
- ▷ Electrical power section easily accessed for maintenance.

# Plus:

### With the C72 alone it is possible to:

- ▶ **Read**, on a specific indicator panel, the position of the gauge inside the wheel in order to mount the counterweight in the exact position.
- ▶ **Correct**, behind the wheel spokes, with simple and clear indications through specific Leds.
- ▶ **Obtain indications** which are more explicit and clear through Led indicator sets.
- ▶ **Automatically measure** wheel width using the optional **LA SONAR** (CEMB patent), without using mechanical probes.
- ▶ **Measure dimensions** with the simple CEMB "intelligent" gauge system.
- ▶ **Minimise static residual unbalance** using 5 by 5 grams counterweights (CEMB patent).
- ▶ **Balance** spoked wheels with a single weight, leaving a residual unbalance within the set tolerance level (CEMB patent).



► C72 SE

With rapid and precise pneumatic wheel locking (CEMB patent).

75 mm hold excursion: ideal for minimising operator manual intervention.

Does not require threaded lock ring or other specific devices.

Better precision, thanks to the high and constant tightening force independent of the power supply air pressure.

Safe, thanks to the pedal system with retainer.

Adaptable, in the event that stud bolt flange-adapters are used.

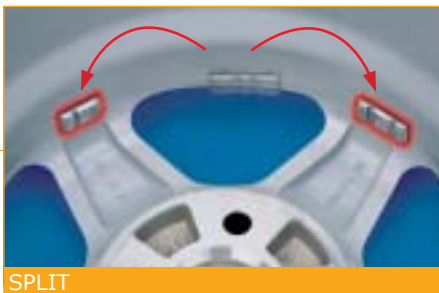

SPLIT



► "Automatic" minimisation of static unbalance

Initial unbalance	Default	Possible approximations		
Inside 23 g - Outside 18 g Angle 50°	Inside 25 g - Outside 20 g Static residual 4 g	Inside 25 g - Outside 15 g Static residual 3 g	Inside 20 g - Outside 20 g Static residual 1 g	Inside 20 g - Outside 15 g Static residual 6 g
	By conventional wheel balancer	Select with CEMB minimisation		

Indicates the optimal value of weights to apply, by using an "intelligent" averaging system to minimise residual static unbalance unavoidable by using the standard weights on the market, available in 5 g ranges.

The static unbalance is the major cause to most car vibration. Thanks to static minimisation, balance quality appreciably improves with no effort and no loss of time for operator.

► Ease of use



ALU-S



LA SONAR



EMS SONAR

## ▶ Technical data

Standard power supply	115-230 V single phase 50/60 Hz
Max absorbed power	1100 W
Balancing speed	180 rpm
Balancing accuracy	1 g
Cycle time	6 seconds
Rim diameter	from 10" to 26" (from 265 to 660 mm)
Rim width	from 1,5" to 20" (from 40 to 510 mm)
Max wheel diameter (with wheel guard)	950 mm
Max wheel weight	70 Kg
Gross weight	140 Kg
Overall dimensions (mm)	1315x1690x1865 h
Packing dimensions (mm)	1450x1040x1750 h

## ▶ Accessories

### ▶ standard

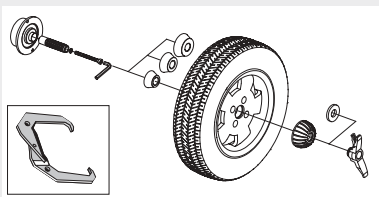

▶ **UC20 cone adapter** with **GP** quick locking for wheels with central hole  $\varnothing$  from 43 to 110 mm.

▶ **Gauge** for wheel width measurement, only for machines without LA option.

### ▶ for SE2 pneumatic locking

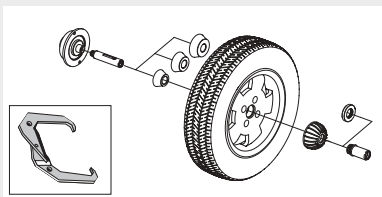

▶ **UC20-SE2 cone adaptor** for wheels with central hole  $\varnothing$  from 43 to 110 mm.

▶ **Gauge** for wheel width measurement, only for machines without LA option.

### ▶ options to be used on the cone adapter

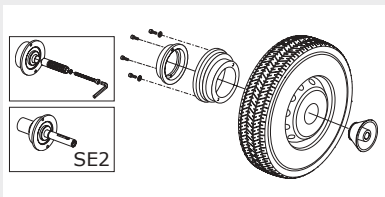

▶ **VL/2 cone kit** necessary to lock light truck wheels with central hole  $\varnothing$  from 97 to 180 mm.

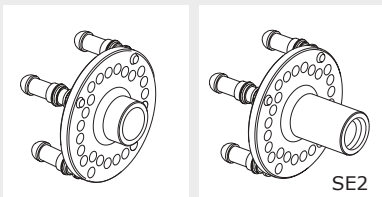

▶ **Adapters** with centering studs:  
- **SR** standard  
- **SR-SE2** for pneumatic locking.

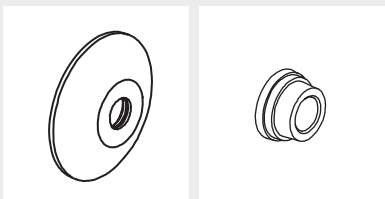

▶ **RL hollow sleeve**  $\varnothing$  206 mm, for alloy rims.

▶ **MT stepped cone** for German car rims ( $\varnothing$  56,5 - 57 - 66,5 - 72,5 mm).

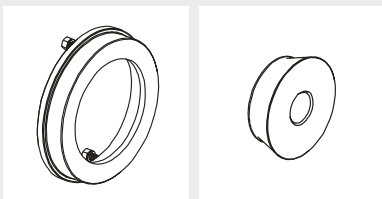

▶ **WD spacer** for car wheels with deep off-set and for off-road wheels.

▶ **J cone** for off-road vehicle with hole  $\varnothing$  from 101 to 119 mm.

### ▶ options

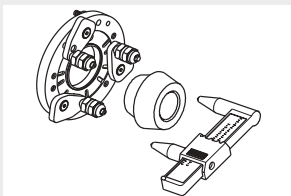

▶ **UH20/2** for wheels with 3-4-5 holes, with/without central hole on a  $\varnothing$  from 95 to 210 mm. The additional cone (CEMB patent), in the majority of cases, allows to center the wheel from inside on the central hub seat, thus improving balancing accuracy respect to the traditional adapters on the market.

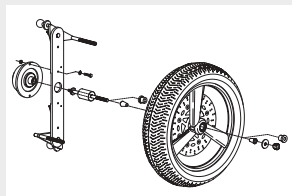

▶ **RMC20 MOT** universal adapter for standard and flanged or side hung motorcycle wheels (BMW - Aprilia - Honda - Ducati - etc.) and scooter wheels.

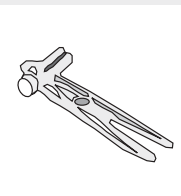

▶ **Pincer-hammer** for counterweights.



**CEMB S.p.A.**  
Via Risorgimento, 9  
23826 MANDELLO DEL LARIO (LC) Italy  
www.cemb.com  
e-mail: cemb@cemb.com

**Garage equipment division:**  
phone +39 0341 706369  
fax +39 0341 700725  
e-mail: gar-eq@cemb.com



All the data and features mentioned in this catalogue are purely for information and do not constitute any commitment on the part of our company, which reserves the right to make any and all alterations it may consider suitable without notice.

