

# THREE STAR

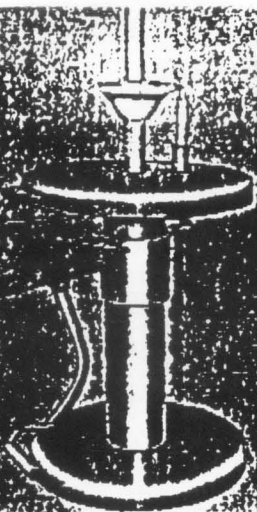

This Parts List is for  
machines with  
Serial No. 3S-001 and up  
Manufactured by  
The Coats Co., Inc.  
P. O. Box 817  
Fort Dodge, Iowa 50501  
TWX: 910-520-2480 Ft. Dodge, Iowa  
CABLE: HENNESTAR Ft. Dodge, Iowa

ORDER PARTS FROM YOUR DISTRIBUTOR OR JOBBER

## PARTS PRICE LIST

EFFECTIVE DATE MAY 1, 1965

| Ref. No. | Part No. | Description  |
|----------|----------|--|
| 1        | 000307   | Positioning Pin Only.....                          |
| 2        | 000310   | Positioning Pin Bumper.....                        |
| 3        | 000305   | Positioning Pin Holder.....                        |
| 4        | 000516   | 3/8" Lock Nut (Ea.).....                           |
| 5        | 000306   | Positioning Pin Complete.....                      |
| 6        | 000278   | 3/8" x 2-1/4" Bolt.....                            |
| 7        | 000308   | Positioning Pin Spring.....                        |
| 8        | 000311   | 7/16" x 3/4" Bolt (4).....                         |
| 9        | 000322   | Lower Bead Loosener Shoe.....                      |
| 10       | 000516   | 3/8" Lock Nut (Ea.).....                           |
| 11       | 000213   | Cam Arms (2).....                                  |
| 12       | 000516   | 3/8" Lock Nut (Ea.).....                           |
| 13       | 000319   | Cam Roller (Ea.).....                              |
| 14       | 000221   | Lower Bead Loosener Handle.....                    |
| 15       | 000279   | 3/8" x 2-3/4" Bolt.....                            |
| 16       | 000218   | 3/8" x 1-1/4" Roll Pin.....                        |
| 17       | 000298   | Lower Bead Loosener Handle Pin<br>Bushing.....     |
| 18       | 000586   | 3/8" x 2-1/2" Bolt.....                            |
| 19       | 000586   | 3/8" x 2-1/2" Bolt.....                            |
| 20       | 000215   | Cam Arm Pivot Spacers (2).....                     |
| 21       | 000200   | Chassis.....                                       |
| 22       | 000304   | 3/8" x 1-3/4" Roll Pin.....                        |
| 23       | 000303   | Swivel Collar.....                                 |
| 24       | 000301   | Center Column (Mfg. Prior to<br>Dec. 1, 1961)..... |
| 25       | 000503   | New Center Column.....                             |

| Ref. No. | Part No. | Description   |
|----------|----------|---|
| 26       | 000437   | Cap Tube.....   |
| 27       | 000302   | Swivel Unit (Mfg. Prior to<br>Dec. 1, 1961).....        |
| 28       | 000433   | Hold Down Cone.....                                     |
| 29       | 000431   | Finger.....   |
| 30       | 000432   | 3/8" x 1" Roll Pin.....                                 |
| 31       | 000324   | Combination Tool Under Bead<br>Roller.....              |
| 32       | 000327   | Combination Tool Dismounting<br>Bead Roller.....        |
| 33       | 000328   | Combination Tool Dismounting<br>Bead Roller Screw.....  |
| 34       | 000325   | Combination Tool Under Bead<br>Roller Shafts (2).....   |
| 35       | 000326   | Combination Tool Under Bead<br>Roller Shaft Spring..... |
| 36       | 000469   | Combination Tool (Complete).....                        |
| 37       | 000330   | Combination Tool Mounting<br>Bead Roller.....           |
| 38       | 000331   | Combination Tool Mounting Bead<br>Roller Screw.....     |
| 39       | 000335   | Upper Bead Loosener (cpt.).....                         |
| 40       | 000516   | 3/8" Lock Nut (Ea.).....                                |
| 41       | 000337   | Upper Bead Loosener Handle.....                         |
| 42       | 000338   | Upper Bead Loosener Shoe.....                           |
| 43       | 000336   | Upper Bead Loosener Arm.....                            |
| 44       | 000551   | 3/8" x 1-3/8" Bolt (Ea.).....                           |

# COATS THREE STAR PARTS PRICE LIST

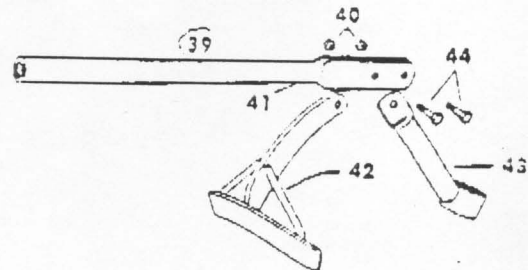
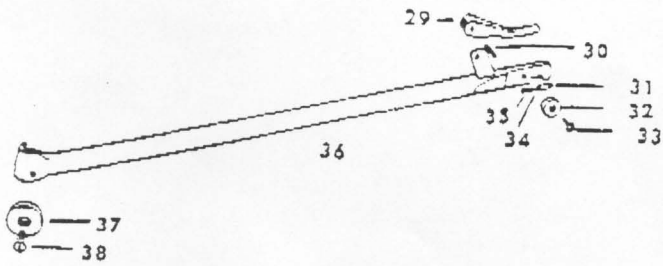
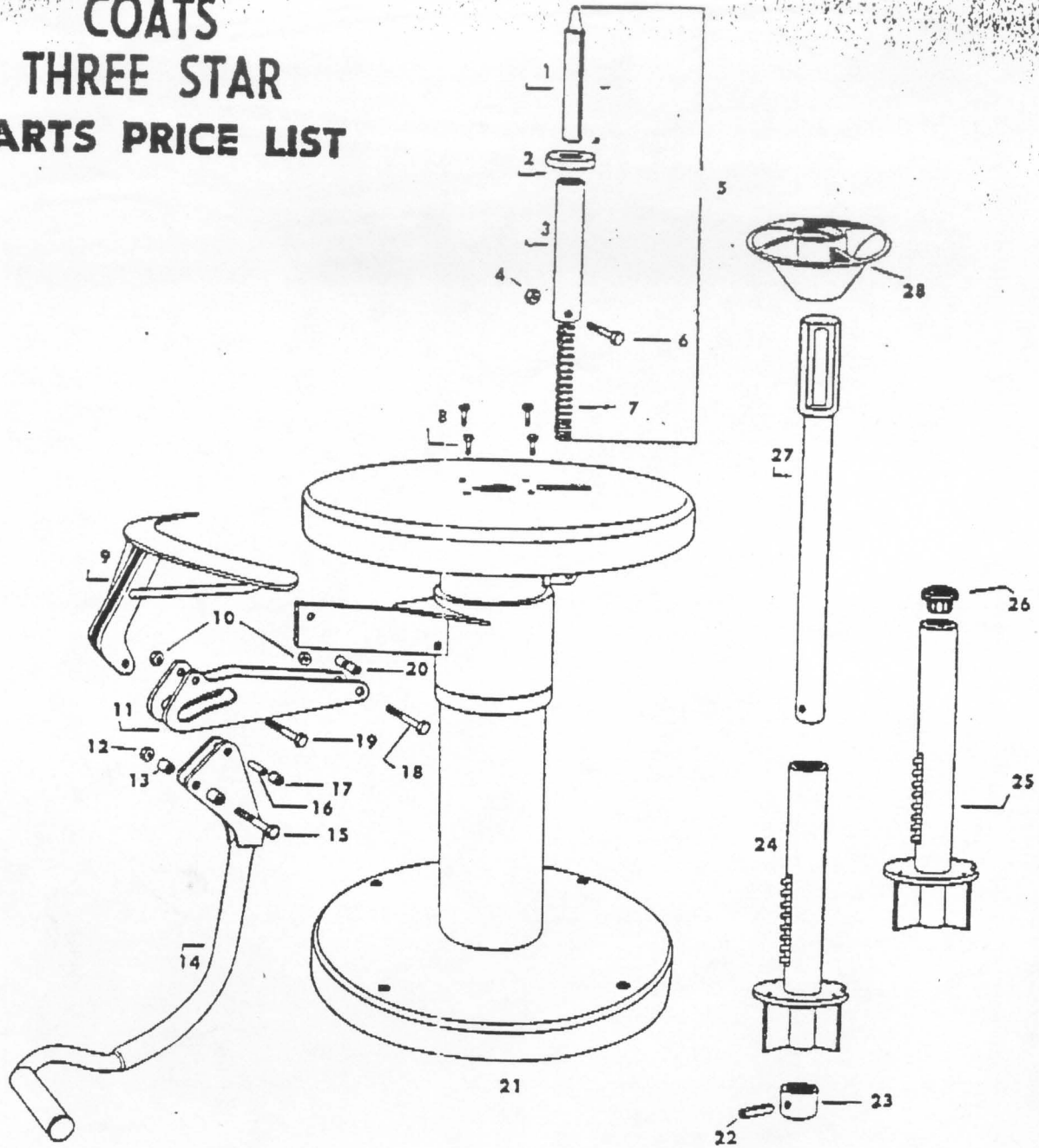

When ordering parts always give the following information:  
 (1) Part Number (2) Description (3) Serial Number of Your Machine